

THE FUTURE OF OPEN BUILDING

Actor Networks that Shape Design
September 10, 2015
DAY 2

Time	Detail
8:00	Coffee & Registration
8:45	Welcome from ETH CASE Co-Director Dr. Margrit Hugentobler (CH), ETH Zürich Keynote Introduction by ETH Dean of Architecture Professor Annette Spiro (CH), ETH Zürich
9:00	Keynote Speaker: Frank Bijdendijk (NL), Bijdendijk Consult
9:45	Panel Introduction by Moderator Associate Professor Dr. Amira Osman (SU/SA) University of Johannesburg Panel Focus: The Dynamics of Networks Beyond Europe
10:00	Panelist 1: Professor Dr. Arno Schlüter (DE) ETH Zürich, Future Cities Singapore, Keoto AG
10:10	Panelist 2: Professor Alfredo Brillembourg (VE) ETH Zürich, Urban Think Tank
10:20	Panelist 3: Professor Dr. Bernardo Gomez-Pimienta (MX/BE) Architecture School at the Anahuac University, BGP Arquitectura
10:30	Moderated Discussion
11:15	Keynote Introduction by ETH CASE Professor Dietmar Eberle (AT), ETH Zürich, Baumschlager Eberle Keynote Speaker: Anne Lacaton (FR) Lacaton & Vassal
12:00	Lunch Afternoon Program Options A, B or C
13:00	Option A: Zürich Cooperative Housing Tour* led by Barbara Petri (DE)
13:30	Option B: Transformations in West Zürich Tour* led by Claudia Mallien (CH)
13:30	Option C: Film Screening of CASE STUDIES NL followed by a Q&A with the filmmakers Film introduction and panel moderation by ETH CASE Dr. Jan Silberberger (DE) Panelists: Beate Lindt (DE) and Assistant Prof. Gerald Lindner (KE), Eindhoven University of Technology
16:00	Coffee Break
16:30	Program Ends for the Day
18:30	Dinner Gala @ Restaurant LaSalle in the Schiffbau**

*Registration is required.
**Supplementary fee applies.

Transformations of the Built Environment
September 11, 2015
DAY 3

Time	Detail
8:00	Coffee & Registration
8:45	Welcome from ETH CASE Co-Director Dr. Marie Glaser (DE) Keynote Introduction by Professor Alfredo Brillembourg (VE) ETH Zürich, Urban Think Tank
9:00	Keynote Speaker: Professor Yung Ho Chang (CN) Massachusetts Institute of Technology MIT Atelier Feichang Jianzhu
9:45	Panel Introduction by Moderator Professor Kerstin Höger (DE) Norwegian University of Science and Technology Panel Focus: Links between Europe and East Asia
10:00	Panelist 1: Martin Henn (DE) Henn Architects
10:10	Panelist 2: Hiromi Hosoya (JN) Hosoya Schaefer Architects
10:20	Panelist 3: Professor Renee Chow (US) University of California, Berkeley Studio Urbis
10:30	Moderated Discussion
11:15	Synthesis by ETH CASE Professor Dietmar Eberle (AT), ETH Zürich, Baumschlager Eberle
12:00	Program Ends for the Event

Our media partners:

TEC21 TRACÉS   x!mage

How can we design large projects without necessarily imposing uniformity and rigidity where variety and adaptability over time are desirable?

Habraken, N.J. 1967. The control of complexity. Places 4 (2) 3.

The origins of 'open building,' a term coined by Age van Randen at TU Delft in the eighties, developed from the ideas of N. John Habraken, the Dutch architect and the director of the Foundation for Architects' Research (SAR), whose work had the specific aim of reinvigorating housing industrialization through a research agenda focused on the relationships between the profession of architecture and the housing industries, emphasizing the varied roles users could take in the process.

Specifically in his 1962 book, Supports: An Alternative to Mass Housing, Habraken combined many forward-thinking perspectives that are now widely accepted in the research and practice of architecture, urbanism and the social sciences such as: designing for openness, which involves not only capacity, but inclusivity; the recognition that many actors influence design and construction processes; and not least, the ongoing transformative properties of the built environment.

The conference organizers of THE FUTURE OF OPEN BUILDING have invited speakers and paper presentations to clarify how these core perspectives come together within case studies of various development typologies, as well as to challenge which directions 'open building' should take in the twenty-first century.

ETH Wohnforum
ETH CASE
Host



Honorary Partner

Who we are.
What we do.

ETH Wohnforum - ETH CASE (Centre for Research on Architecture, Society & the Built Environment) was founded in 1990 as an interdisciplinary research centre at the ETH Zürich Department of Architecture. Our research addresses questions of dwelling that we consider a dynamic, multi-layered blend of socio-cultural, historical and technical phenomenon to be accessed in relation to current contextual developments in architecture, urban design and planning.

THE FUTURE OF OPEN BUILDING

CONFERENCE at ETH Höggerberg
September 9-11, 2015

ETH Wohnforum - ETH CASE - Centre for Research
on Architecture, Society & the Built Environment

Three days of program that includes:
keynote speakers,
moderated panels,
technical tours,
parallel case study sessions,
a film screening
and Q&A with the filmmakers,
plus a welcome apéro
in the ETH Alumni Lounge
with remarks from
City of Zürich Mayor
Corine Mauch.

Gala honoring special guest
N. John Habraken
at Restaurant LaSalle
in the Schiffbau.

General Information

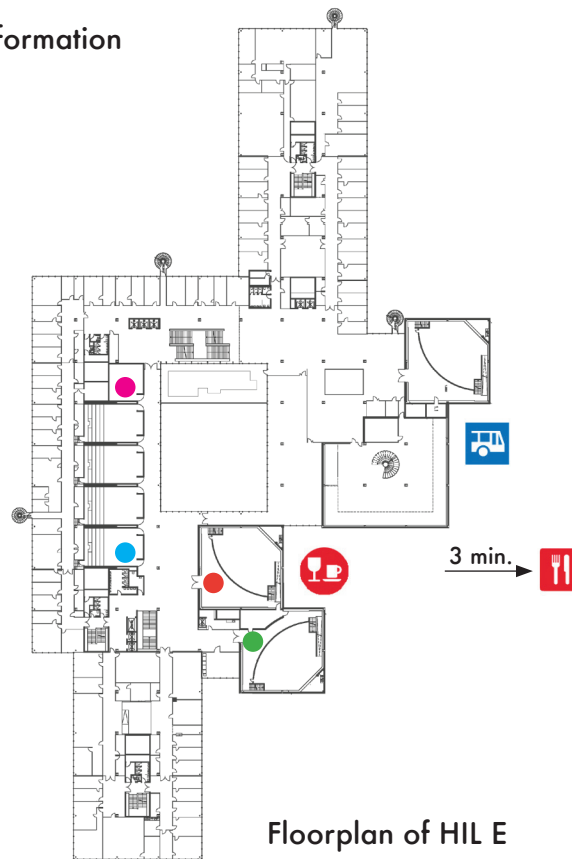

Floorplan of HIL E

HIL E is one floor above the
ground floor.

Room	Detail
● HIL E 3	Morning Program Paper Session A
● HIL E 4	Paper Session B
● HIL E 9	Paper Session C
● HIL E 5	OB Meeting

Symbol	Points of Relevance on the ground floor
	Bus Stop
	Alumni Lounge
	Hexagon Canteen

Internet Access

Step	Detail
1	Connect to WLAN 'public' or 'public 5'
2	Open a browser and an external site, where you will be prompted to enter the login and password.
3	Enter the login: OpenBuilding Enter the password: Wohnforum

Conference Access

The lower right corner of your name
tag indicates what kind of access you
have during the conference.

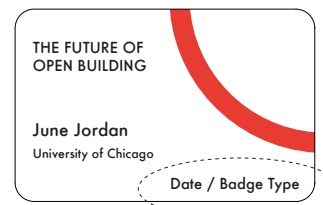

Type	Detail
H	Lunch in the Hexagon Canteen Access to keynotes, panels and paper sessions. Coffee breaks, the welcome apéro and the option to sign up for the technical tours are included.
A	Lunch in the Alumni Lounge Access to keynotes, moderated panels and paper sessions. The welcome apéro and the option to sign up for the technical tours are included.
G	Guest Pass Access to keynotes, panels, paper sessions, coffee breaks and the film screening. Lunches, the welcome apéro and access to the technical tours NOT included.

Designing for Openness September 9, 2015 DAY 1

Time	Detail
8:00	Coffee & Registration
9:45	Welcome from the ETH Rector Professor Dr. Sarah Springman (GB), ETH Zürich Welcome and Keynote Introduction by ETH CASE Professor Dietmar Eberle (AT), ETH Zürich, Baumschlager Eberle
10:00	Keynote Speaker & Panel Moderator: Giorgio Macchi (CH), Former Chief Architect of Bern
10:30	Panel Introduction by Moderator Panel Focus: Local Approaches to Design, Development and Construction Processes
10:45	Panelist 1: Anna Schindler (CH), Director of Urban Development, City of Zürich
10:55	Panelist 2: Roland Stulz (CH) Co-Founder of the 2000 Watt Society President, INTEP AG
11:05	Panelist 3: Ute Schneider (DE) Director, KCAP Architects and Planners
11:15	Moderated Discussion
12:00	Lunch
13:15	Afternoon Parallel Paper Sessions A, B and C
15:30	Coffee Break
16:00	Parallel Paper Sessions continue
18:30	Apéro in the ETH Alumni Lounge
18:45	Welcome to the City by Corine Mauch, Mayor of the City of Zürich
19:30	Program Ends for the Day

Many thanks to our generous supporters:

ETH zürich

DARCH

Pensimo

